

FOSHAN SHUNDE SAIER SENSOR CO., LTD.

SEN-HZ83K
Product Data Sheet

I. Specification (mm)

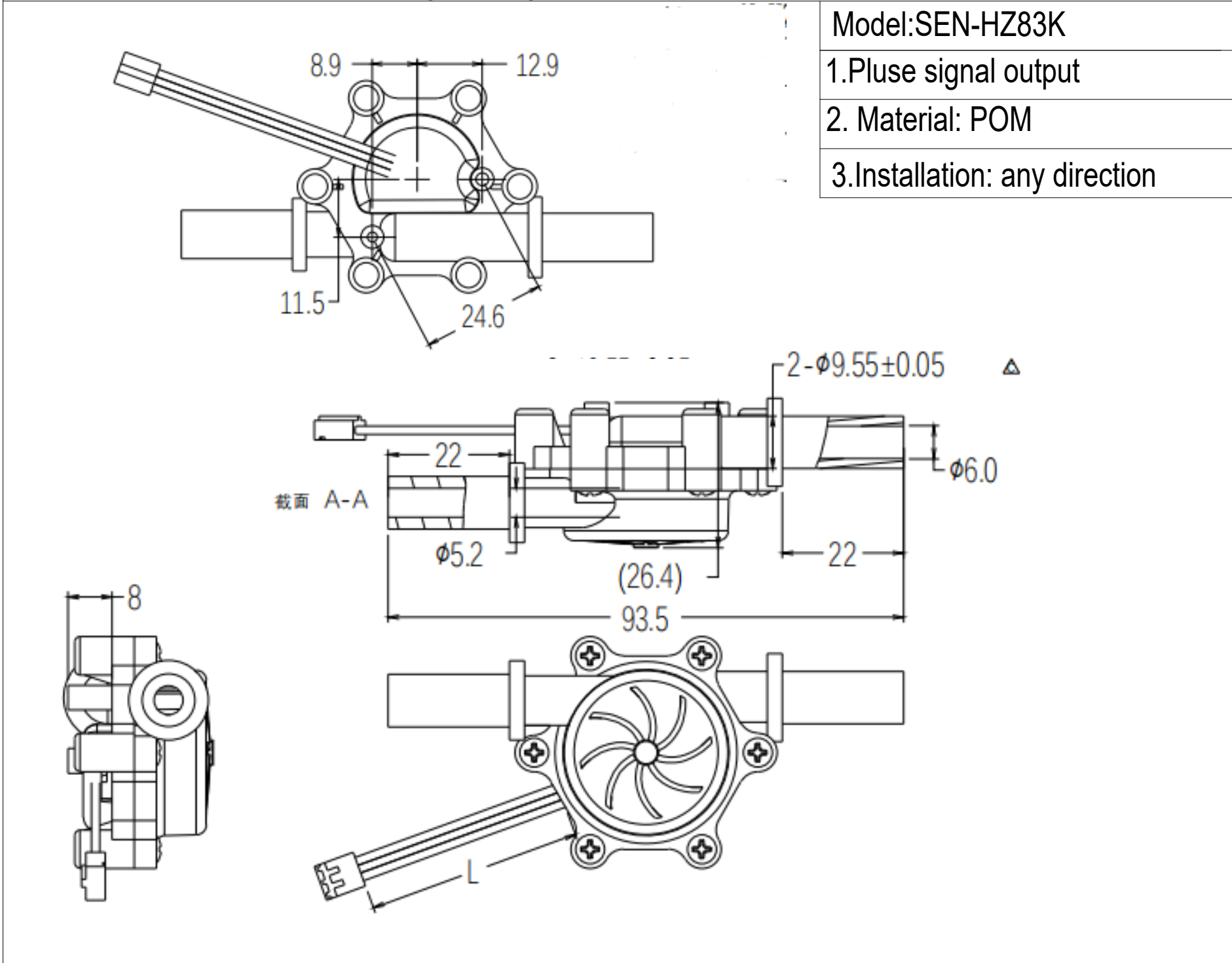

III. Characteristic for flow range

1. Instant flow Pulse characteristics: $F=(19Q-2) \pm 10\%$ (Just for your reference)

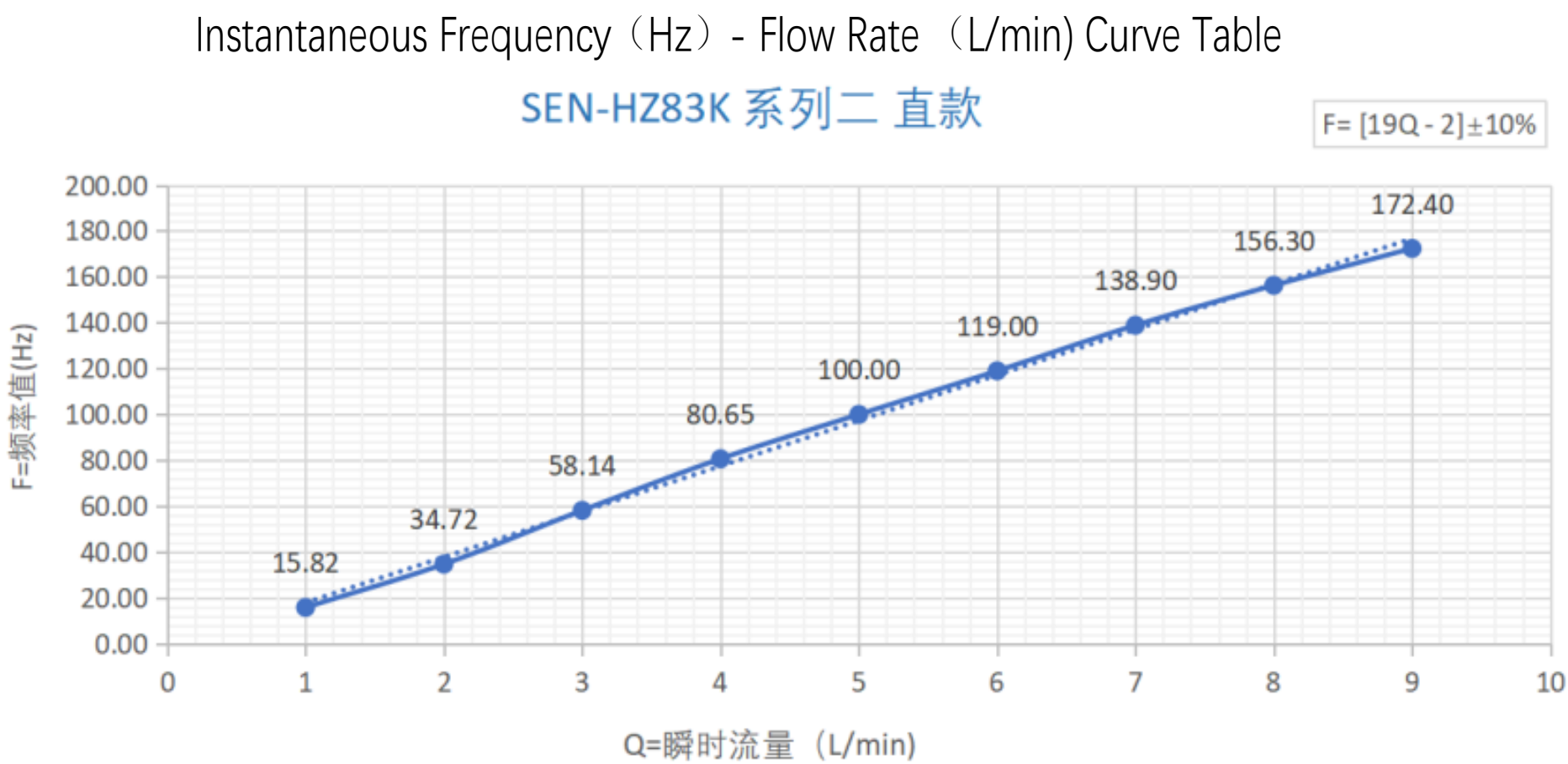

Flow characteristics laboratory measured parameters comparison table

L/min(流速) (flow rate)	1L	2L	3L	4L	5L	6L	7L	8L	9L
脉冲数(水平) (Pulse data horizontal)	15.82	34.72	58.14	80.65	100	119	138.9	156.3	172.4

II. Technical parameters:

Temperature	water normal temp. $\leq 60^{\circ}\text{C}$, high temp. $\leq 115^{\circ}\text{C}$		
Operating voltage range	3V:1. 8-5. 5V	5V:2. 2-18V	24V:4. 5-26. 4V
Rated voltage/current	DC3V, $\leq 10\text{ }\mu\text{A}$	DC5V, $\leq 10\text{mA}$	DC5V, $\leq 10\text{mA}$
Output voltage Duty cycle 50%	rated voltage $<$ DC5V, high level above: Vcc-0.2V, low level below: 0.2V rated voltage \geq DC5V, high level above: Vcc-0.5V, low level below: 0.5V		
Insulated resistor	$>100\text{ M}\Omega$		
Electrical strength	AC500V, 50Hz		
Flow range	0.3-10L/min		
Pressure performance	$\leq 1.5\text{Mpa}$		

IV. Instruction:

- 1.In order to avoid particles, debris into the sensor, the sensor inlet must be installed filter.
 - 2.Water flow sensor installed in the equipment inside or indoors, do not expose for a long time outdoors or high humidity.Under harsh environment such as temperature, to avoid strong vibration and shake the environment, to avoid affecting the sensor measurement Measuring accuracy.
 - 3.When a magnetic material or a material which generates magnetic is close to the sensor, the characteristic may change.
 - 4.Do not open the flow sensor to prevent damage, where unauthorized dismantling of the flow sensor are not in the scope of the warranty.
 - 5.Not used the structure of the sensor for direct replacement may have discomfort, please prompt;
 - 6.Customer service Tel: 0757-22905969 ; Fax no.0757-22905969.
- <https://www.chnsensor.com> ; E-mail: sales4@chnnsensor.com.
- Remark: Applied to water dispenser, water control machine, coffee machine, water purifier, instrument and meter etc.